

Les Forgerons d'Antan 2012/2013  
Pièces détachées en fer forgé

N°



135x75  
**R63.001**



155x95  
**R63.003**



135x75  
**R63.004**

N°



160x85  
**R63.005**



140x75  
**R63.006**



135x75  
**R63.007**

N°



137x75  
**R63.012**



142x90  
**R63.013**



121x95  
**R63.014**



110x90  
**R63.019**

N°



Ø60  
**R63.002**



85x65  
**R63.008**



70x65  
**R63.009**



65x65  
**R63.010**



55x65  
**R63.011**

N°



70x116  
**R63.015**



90x116  
**R63.016**



60x70  
**R63.017**



60x70  
**R63.018**

Les Forgerons d'Antan 2012/2013  
Pièces détachées en fer forgé



Ø12 / 145x110  
N° **R63.020**



280x90  
N° **R63.024**



380x70  
N° **R63.025**



460x110  
N° **R63.026**



N° **R63.027**



Ø68x110  
N° **R63.028**



155  
N° **R63.029**



125  
N° **R63.030**



HxL (mm) Ø65  
2  
N° **R63.040**



Ø65  
2  
N° **R63.041**



Ø50  
2  
N° **R63.042**



Ø50  
2  
N° **R63.043**



HxL (mm) Ø50  
4  
N° **R63.044**



Ø50  
4  
N° **R63.045**



130x36  
4  
N° **R63.046**



130x36  
4  
N° **R63.047**



Les Forgerons d'Antan 2012/2013  
Pièces détachées en fer forgé



HxL (mm) 275x130  
3  
N° **R63.101**

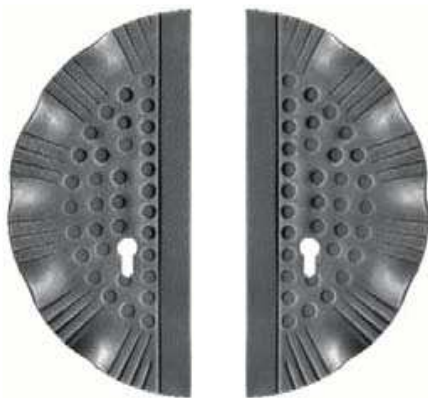

275x130 275x130  
3 3  
N° **R63.102.01 R63.103.01**



290x160 290x160  
4 4  
N° **R63.104 R63.105**



HxL (mm) 305x135  
4  
N° **R63.108**



295x90  
4  
N° **R63.111**



295x120  
3  
N° **R63.114**



275x160 275x160  
3 3  
N° **R63.117 R63.118**



HxL (mm) 275x160  
3  
N° **R63.119.01**



275x160  
3  
N° **R63.120.01**



330x180  
5  
N° **R63.121**



330x180  
5  
N° **R63.122**



HxL (mm) 270x165  
2  
N° **R63.125**



270x165  
2  
N° **R63.126**



280x110  
2  
N° **R63.129**



280x110  
2  
N° **R63.130.01**



280x110  
2  
N° **R63.131.01**

Les Forgerons d'Antan 2012/2013  
Pièces détachées en fer forgé



HxL (mm)

290x160

290x160

290x160

290x160

315x135

2

2

2

2

3

N°

**R63.134**

**R63.135**

**R63.136.01**

**R63.137.01**

**R63.14**



HxL (mm)

330x175

330x175

3

3

N°

**R63.151**

**R63.152**



HxL (mm)

280x140

4

N°

**R63.157**





Les Forgerons d'Antan 2012/2013  
Pièces détachées en fer forgé



HxL (mm)

140x40

200x65

8

10

N°

**R64.001**

**R64.002**

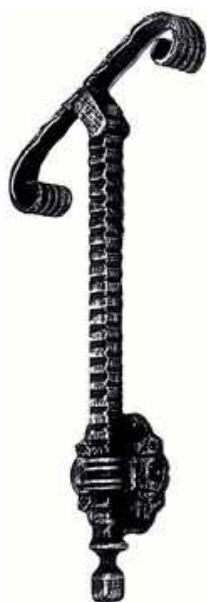

HxL (mm)

420x210

20x20

N°

**R64.010**



180x95

12x12

**R64.011**



HxL (mm)

180x95

12x12

N°

**R64.012**



180x95

Ø14

**R64.013**



HxL (mm)

36xØ19

Ø6

N°

**R64.020**



25xØ25

Ø6

**R64.021**



36xØ18

Ø6

**R64.022**









32xØ21

Ø10

**R64.023**

Les Forgerons d'Antan 2012/2013  
Pièces détachées en fer forgé

							
H (mm)	120	120	120	120	120	120	120
N°	<b>R64.100</b>	<b>R64.101</b>	<b>R64.102</b>	<b>R64.103</b>	<b>R64.104</b>	<b>R64.105</b>	<b>R64.106</b>
H (mm)	170	170	170	170	170	170	170
N°	<b>R64.100.01</b>	<b>R64.101.01</b>	<b>R64.102.01</b>	<b>R64.103.01</b>	<b>R64.104.01</b>	<b>R64.105.01</b>	<b>R64.106.01</b>

							
H (mm)	120	120	120	120	120	120	120
N°	<b>R64.107</b>	<b>R64.108</b>	<b>R64.109</b>	<b>R64.110</b>	<b>R64.111</b>	<b>R64.112</b>	<b>R64.113</b>
H (mm)	170	170	170				
N°	<b>R64.107.01</b>	<b>R64.108.01</b>	<b>R64.109.01</b>				

				
H (mm)	170	170	170	170
N°	<b>R64.110.01</b>	<b>R64.111.01</b>	<b>R64.112.01</b>	<b>R64.113.01</b>



Les Forgerons d'Antan 2012/2013  
Pièces détachées en fer forgé



H (mm)  
N°

1400  
**R65.001**

1200  
**R65.002**



H (mm)  
N°

1400  
**R65.003**

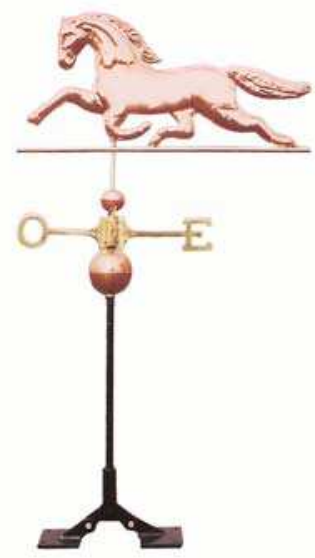

1000  
**R65.004**

Les Forgerons d'Antan 2012/2013  
Pièces détachées en fer forgé



Ø290xH 350  
**R66.001**

N°



H 530xL 290x330  
**R66.002**



H 670xL 310x420  
**R66.003** peinte

H 670xL 310x420  
**R66.003.01** galvanisée



HxL (mm)

400x300

N°

**R66.004** peinte

HxL (mm)

400x300

N°

**R66.004.01** galvanisée



460x240x150

**R66.005** peinte

460x240x150

**R66.005.01** galvanisée



380x290

**R66.006** peinte

380x290

**R66.006.01** galvanisée



## Les Forgerons d'Antan 2012/2013

### Pièces détachées en fer forgé

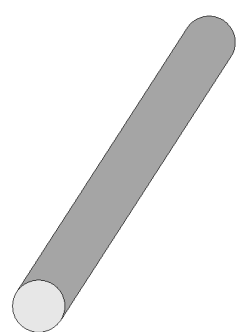

	H	N°
Ø8	1000	<b>R80.008</b>
Ø10	1000	<b>R80.010</b>
Ø12	1000	<b>R80.012</b>
Ø14	1000	<b>R80.014</b>
Ø16	1000	<b>R80.016</b>
Ø18	1000	<b>R80.018</b>
Ø20	1000	<b>R80.020</b>
Ø25	1000	<b>R80.025</b>
Ø30	1000	<b>R80.030</b>

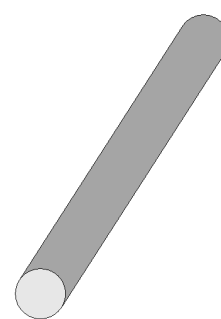

	H	N°
Ø8	3000	<b>R81.008</b>
Ø10	3000	<b>R81.010</b>
Ø12	3000	<b>R81.012</b>
Ø14	3000	<b>R81.014</b>
Ø16	3000	<b>R81.016</b>
Ø18	3000	<b>R81.018</b>
Ø20	3000	<b>R81.020</b>
Ø25	3000	<b>R81.025</b>
Ø30	3000	<b>R81.030</b>

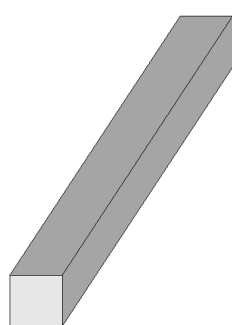

	H	N°
8x8	1000	<b>R82.008</b>
10x10	1000	<b>R82.010</b>
12x12	1000	<b>R82.012</b>
14x14	1000	<b>R82.014</b>
16x16	1000	<b>R82.016</b>
18x18	1000	<b>R82.018</b>
20x20	1000	<b>R82.020</b>
25x25	1000	<b>R82.025</b>
30x30	1000	<b>R82.030</b>

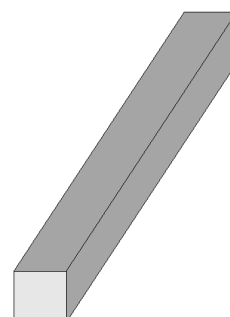

	H	N°
8x8	3000	<b>R83.008</b>
10x10	3000	<b>R83.010</b>
12x12	3000	<b>R83.012</b>
14x14	3000	<b>R83.014</b>
16x16	3000	<b>R83.016</b>
18x18	3000	<b>R83.018</b>
20x20	3000	<b>R83.020</b>
25x25	3000	<b>R83.025</b>
30x30	3000	<b>R83.030</b>

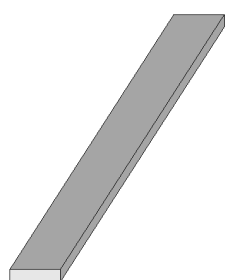

	H	N°
12x6	1000	<b>R84.010</b>
14x6	1000	<b>R84.020</b>
20x5	1000	<b>R84.030</b>
25x5	1000	<b>R84.040</b>
30x6	1000	<b>R84.050</b>
30x8	1000	<b>R84.060</b>
30x10	1000	<b>R84.070</b>
40x6	1000	<b>R84.080</b>
40x8	1000	<b>R84.090</b>
40x10	1000	<b>R84.100</b>
40x12	1000	<b>R84.110</b>
50x8	1000	<b>R84.120</b>
50x10	1000	<b>R84.130</b>
50x12	1000	<b>R84.140</b>

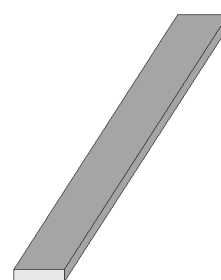

	H	N°
12x6	1000	<b>R85.010</b>
14x6	1000	<b>R85.020</b>
20x5	1000	<b>R85.030</b>
25x5	1000	<b>R85.040</b>
30x6	1000	<b>R85.050</b>
30x8	1000	<b>R85.060</b>
30x10	1000	<b>R85.070</b>
40x6	1000	<b>R85.080</b>
40x8	1000	<b>R85.090</b>
40x10	1000	<b>R85.100</b>
40x12	1000	<b>R85.110</b>
50x8	1000	<b>R85.120</b>
50x10	1000	<b>R85.130</b>
50x12	1000	<b>R85.140</b>

Les Forgerons d'Antan 2012/2013  
Pièces détachées en fer forgé